

Regulus

www.regulus.eu



Wmix-H

Instruction Manual
Wmix-H
Anti-Scald Valve

EN

Wmix-H

OPERATION INSTRUCTIONS

1 - Application

The anti-scald valve is designed for installation in DHW piping. It is used to maintain the DHW temperature at the set value regardless of changes in the temperature of cold water in the supply pipe and hot water in the DHW heater.

2 - Description of the mixing function

The three-way mixing valve is equipped with an integrated thermostatic insert which controls the flowrate through inlet ports "H" (hot) and "C" (cold) so that the preset temperature is reached at the outlet from the "MIX" valve.



Moreover, the valve features an anti-scalding function. In case of cold water supply breakdown, the hot water supply is interrupted as well. This safety function works from 10 K temperature difference between the incoming DHW and mixed hot water. Its functionality can be checked by closing cold water supply; the flow through the thermostatic valve should drop to zero very fast.

For mixing with an anti-scald valve, it is advisable to use the model marked "ZV" with check valves at inlets. In case a pressure difference exists in the thermostatic valve, these check valves prevent backflow. This model is also fitted with a strainer that protects the valve inner components and helps maintain its precision in long-term operation.

3 - Installation

This anti-scald valve shall be installed by a qualified person, in compliance with this Manual and valid rules:

Setting the DHW temperature is possible in the range 35-55 °C. The desired temperature is set by turning the knob.

Max. water temperature is 90 °C.

It is recommended to install shut-off valves for the event of the valve replacement or maintenance.

4 -Recommended hydraulic connection

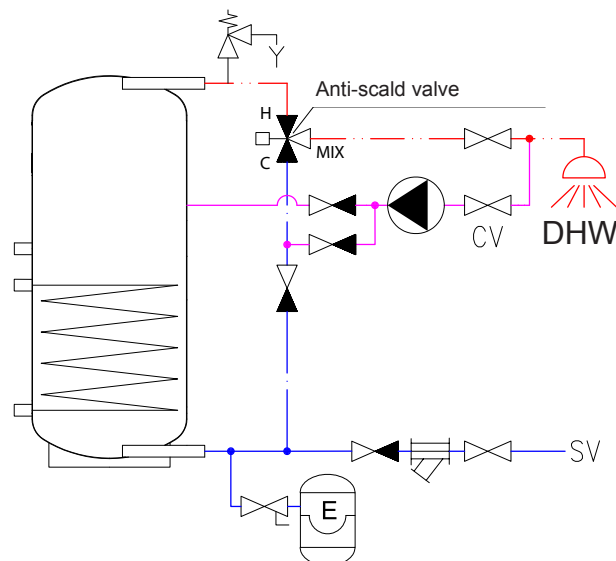

5 - Technical data

Max. static pressure:	10 bar
Temperature adjustment:	35 to 55 °C ± 2 °C
Max. water temperature:	90 °C

Dimensions

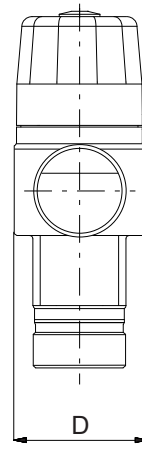
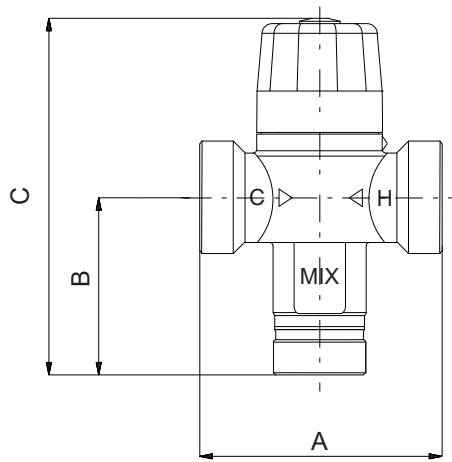

H – hot water in
C – cold water in
MIX – mixed water out

Type	Wmix-H S20	Wmix-H S20 ZV 1/2 M	Wmix-H S25	Wmix-H S25 ZV 3/4 M
Code	20426	20412	20427	20413
A [mm]	60	130	68	148
B [mm]	50	85	50	90
C [mm]	102	137	102	142
D [mm]	39	39	39	39
Connection	3 x G 3/4" M	3 x G 1/2" M	3 x G 1" M	3 x G 3/4" M
Check valve and strainer	no	yes	no	yes
Kvs [m ³ /h]	1.1	0.9	1.3	1.2
Weight [kg]	0.3	0.6	0.4	0.7

WARRANTY CERTIFICATE

Wmix-H Anti-Scald Valve

Purchased from: Date of purchase:

WARRANTY CONDITIONS

1. The warranty period is 24 months from the date of purchase.
2. The product shall be installed and commissioned by a competent company or a person trained by the manufacturer.
3. When claiming warranty, this Warranty Certificate must be submitted together with the purchase receipt.
4. The warranty is valid only when the technical conditions set by the Manufacturer, installation manual and instructions in the documentation and on the product itself are maintained.
5. The warranty does not cover defects caused by external conditions or improper working conditions, defects caused by normal wear and tear, further when the product is not used in compliance with its purpose and when the defect was caused by mechanical damage to the product, improper handling, tampering by a third person, improper installation, improper stocking, natural disaster etc.

COMMISSIONED

BY:

DATE:

Rubber stamp and signature: