

TWO-WAY ZONE VALVES

VZK Two-way Zone Ball Valve

Zone ball valves intended for heating or solar thermal systems with water or antifreeze fluid and for drinking water systems.

The valve is equipped with a **two-point control actuator (SPST)**. The actuator can be removed without disassembling the valve. The valve must not be installed in a position with the actuator facing down.

A working neutral, a permanent phase and a control phase must be supplied to the valve. Without the control phase, the valve is closed, after the control phase is applied, the valve opens fully within 30 seconds.

The valve can be adjusted manually by turning the actuator (it slides out after removing the clip).



The valve is equipped with an anti-blocking function - if the valve ball becomes blocked during closing, e.g. due to dirt in the valve, the actuator automatically changes the direction of rotation and closes the valve on the opposite side.

TECHNICAL DATA

MAX. WORKING PRESSURE	16 bar
MAX. PRESSURE DIFFERENCE	10 bar
FLUID WORKING TEMPERATURE	up to 110 °C

MATERIALS

VALVE HOUSING	brass, forged, nickel-plated
VALVE SPINDLE	nickel-plated brass
VALVE BALL	chrome-plated brass
O-RINGS	FPM
POWER CABLE	PVC

ACTUATOR

POWER SUPPLY	230 V 50 Hz
POWER INPUT	7 W
CURRENT	30 mA
IP RATING BY EN 60529	IP 44
PROTECTION CLASS BY EN 61140 ed.2	II

POWER CABLE

CROSS SECTION	4× 0.5 mm ²
LENGTH	0.3m

VALVE PRESSURE DROP

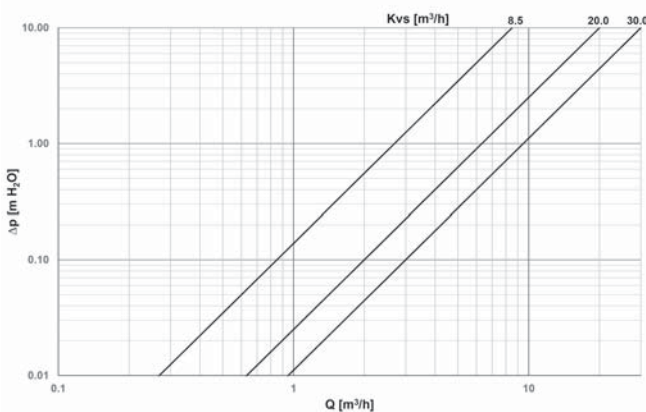

DIMENSIONS AND TYPES

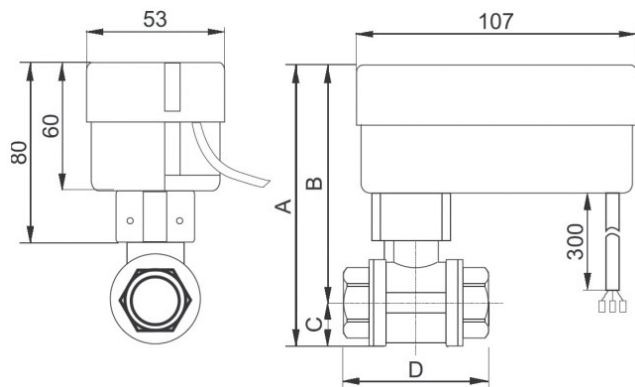

		VZK 215-230-1P	VZK 220-230-1P	VZK 225-230-1P
CONNECTIONS	--	1/2" F	3/4" F	1" F
A	mm	126.0	129.0	137.0
B	mm	108.5	109.5	113.5
C	mm	17.5	19.5	23.5
D	mm	63	57	68
WEIGHT	kg	0.68	0.65	0.81
KVS	m ³ /h	8.5	20.0	30.0
CODE	--	11288	10344	11289

ELECTRICAL WIRING

